

## 规格承认书

## Specification for approval

产品名称: AB11 Mini 迷你插片汽车保险丝 32V

**Product Type: AB11 Plug In Zinc Alloy Automotive Fuses Mini Auto**

**Blade Fuse Rated 32VDC 20A Yellow 11mm For Automotive Passenger Car**

**Ao littel Technology Co.Ltd.**

Bld. 16,Yanhe East Road,Xiangdong Village, Dongguan 523833,  
Guangdong,China

H.P.: 1371362419

Fax #:0769-89390418

QQ #: 3217998702

Email : eric.lye@aolittel.com

<http://www.passivemall.com/>

<http://www.aolittel.com/>

**1. Scope**

Mini Auto Blade fuses shown are for in motor vehicles, boats and trailers to protect ect electrical wiring and equipment. This standard is for the construction shown and is not intended to restrict the design and use of other configurations and materials capable of meeting the vehicle requirements.

**2. Definition**

Miniblade Fuse is quickly becoming the new standard for vehicle circuit protection throughout the world. Its miniature design, meets the need for more circuits to be protected while utilizing less space, and its ability to cope with high temperatures in adverse environments makes the MINI Fuse the recommended choice for protection.

**3. Operation standard:** SAE J2077 Special Purpose Fuse

**4. Dimension (mm)**

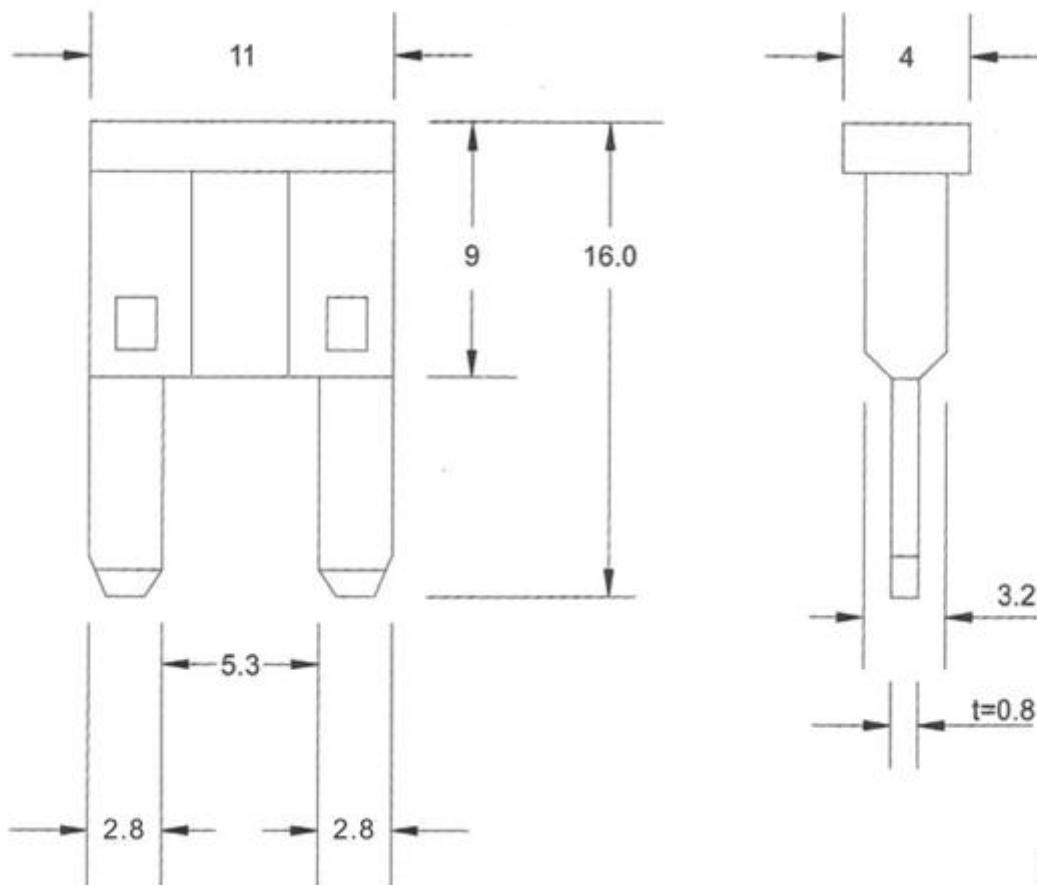

Fast Acting, Low Voltage For UP To 32v DC

Material

\*Body: Plastic.  
\*Metal: Zinc Alloy

Standard

According To SAE J2077

To Permit More Fuses in The Same Amount of Space

Fuses Are Color-Coded For Easy Amperage Identification.

### 5. Time-Current Characteristics

In	1.1In	1.35In		2.0In		3.5In		6.0In	
1-35A	>100Hours	Min.	Max.	Min.	Max.	Min.	Max.	Min.	Max.
		0.75 s	1800 s	0.15 s	5 s	0.04 s	0.5 s	0.02 s	0.1 s

### 6. Electrical Performances

Part Number	Ampere(A)	VoltageVDC	Body Color
AB11001	1A	32V	Black
AB11002	2A	32V	Lt.Gray
AB11003	3A	32V	Violet
AB11004	4A	32V	Pink
AB11005	5A	32V	Tan
AB11075	7.5A	32V	Brown
AB11010	10A	32V	Red
AB11015	15A	32V	Blue
AB11020	20A	32V	Yellow
AB11025	25A	32V	Natural
AB11030	30A	32V	Green
AB11035	35A	32V	Purple

### 7.Product Photo

